

STEP-BY-STEP ASSEMBLY

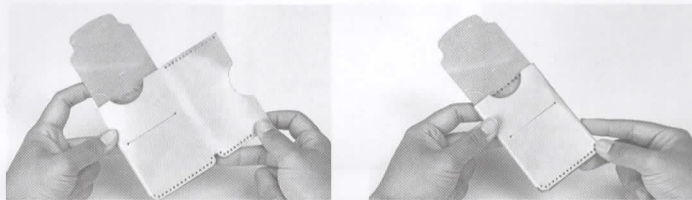

Step 1.
Place the leather panel face down with the longer section positioned on the right. Fold the center section inward, then fold the left section to the back.

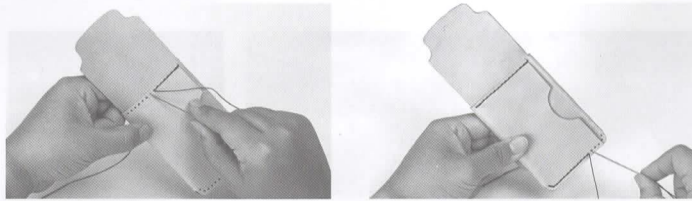

Step 2.
Turn to the back side, align the stitching holes at the top and sew them together.

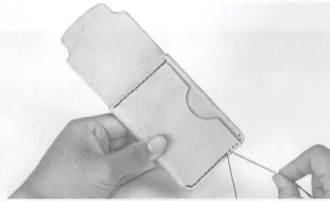

Step 3.
Align the holes at the bottom and sew three layers of leather together.

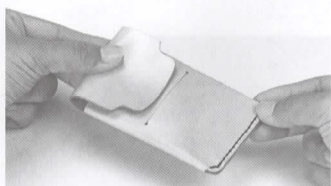

Step 4.
Fold the flap down and insert into the front slot.

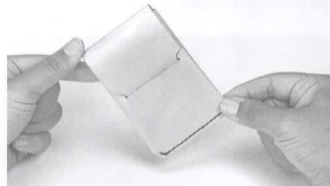

Step 5.
Complete.

COPYRIGHT © 2025 IVAN LEATHERCRAFT CO., LTD. ALL RIGHTS RESERVED

MakerAid®

44178-14

REMY MONEY CARD POUCH LEATHERCRAFT KIT

LEVEL 1



Finished size:
65 X 105 X 10mm
2 9/16" X 4 1/8" X 3/8"

Kit Includes:
- Leather pieces
- Needles
- Thread
- Instruction

**Step-by-Step
Instruction Video:**



Read all instructions carefully before assembly

VEG-TAN LEATHER 101

Vegetable-tanned (veg-tan) leather is a natural, durable material that develops a rich patina over time. Tanned using plant-based extracts, it has a distinct look and feel, making it ideal for tooling, stamping, and dyeing. Its surface, known as **the grain side, is smooth and refined, typically used as the outer layer in leather goods. The rougher flesh side faces inward**, adding structure while remaining unseen. Veg-tan leather's unique aging process and versatility make it a favorite for crafting durable, personalized leather pieces.

KIT COMPONENT

Leather pieces, 2 needles, threads

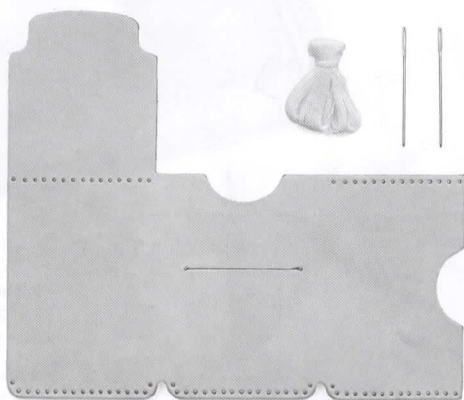

TOOLS REQUIREMENT

Scissors

SADDLE STITCHING INSTRUCTION

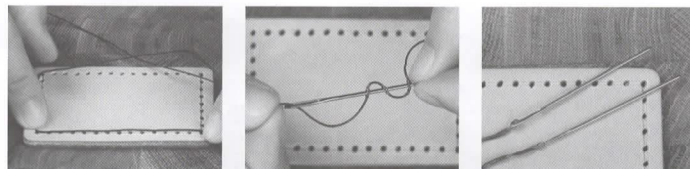

1. Prepare Your Thread
Measure the thread by multiplying the seam length by 2.5.

2. Thread Your Needles
Thread each end of the thread through a needle, pull 2 inches through, and loop it back into the thread to lock it in place.

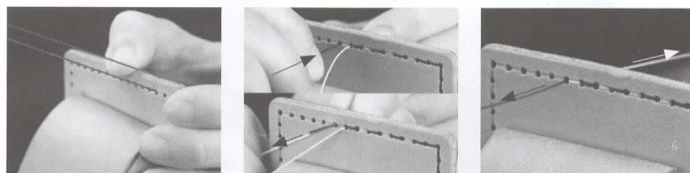

3. Start Stitching
Hold your leather securely or use a stitching pony. Start at the furthest hole, pulling the thread so it's even on both sides.

4. Continue Stitching
Insert the left needle through the next hole, pull the thread tight, and repeat with the right needle. Continue this pattern until the end of the seam.

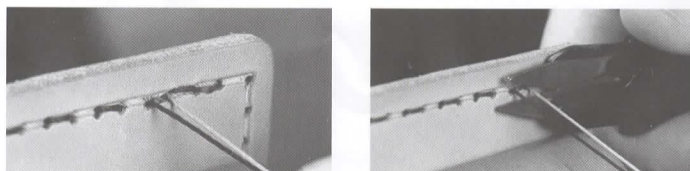

5. Backstitch to Secure
Reverse the stitch for 2-3 stitches to lock the seam and prevent unraveling.

6. Trim the Thread
Cut the thread close to the leather with a sharp blade.